

Installation and Usage Tutorial

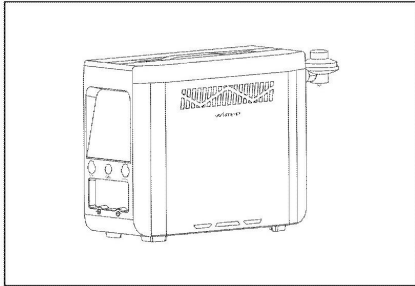

Fig.1

Place the appliance on a solid, non-combustible surface and straighten out all hoses to remove any kinks or twists.

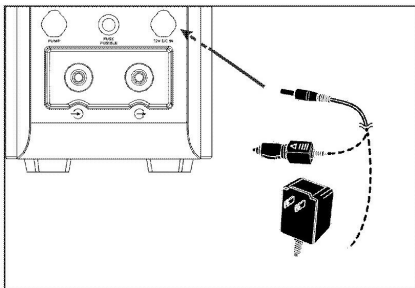

Fig.2

Charge the battery before using the water heater for the first time.

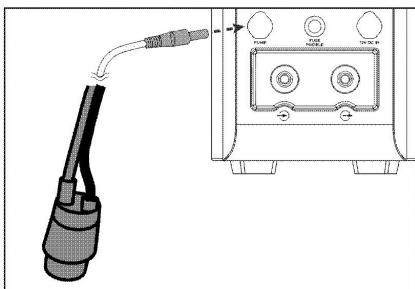

Fig.3

Plug the power cord of the pump into the power input labeled PUMP.

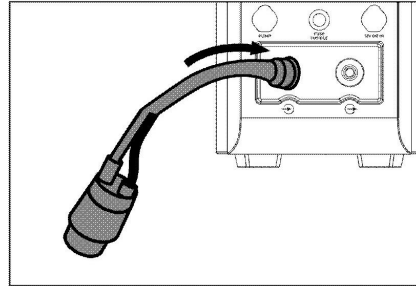

Fig.4

Connect the pump assembly into the water inlet.

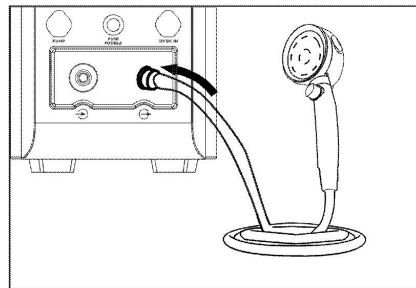

Fig.5

Attach the shower hose using the quick connect fitting, and ensure that the flow switch on the shower head is in the ON position.

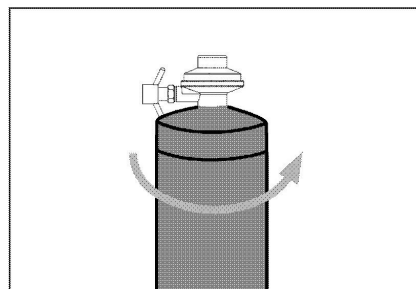

Fig.6

While holding the propane cylinder upright, thread it into the regulator and tighten correctly.

NOTE: This appliance shall only be used with 1 lb. Propane LPG disposable gas cylinders.

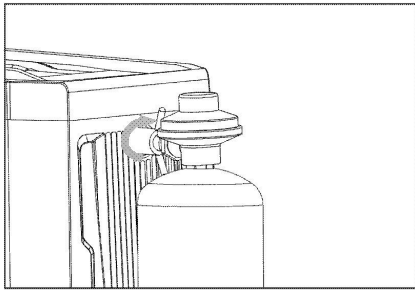

Fig.7

Install the regulator assembly to the appliance
When installing the regulator assembly, push it in slightly and hold so that it can press against the gas inlet connector, then turn the T-nut to tighten it at the same time.

Tips: Press the air valve tightly with one hand, and tighten the T-nut with one hand

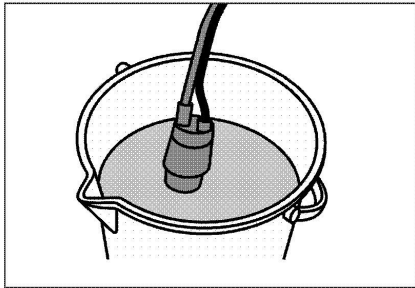

Fig.8

Submerge the pump in a suitable reservoir of water, DO NOT use water directly from rivers, lakes or the ocean. DO NOT use salt water with this appliance.

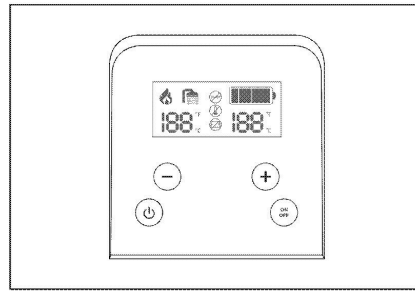

Fig.9

The main power switch "⏻".
Start-up feedwater pump "ON/OFF".

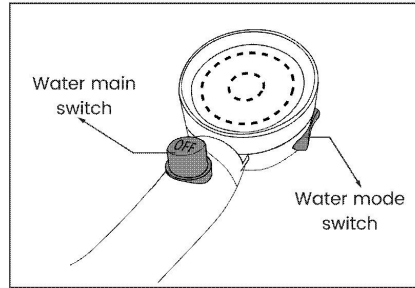

Fig.10

Sliding the flow switch to the OFF position, the burner will extinguish and the pump will continue to operate 120s.

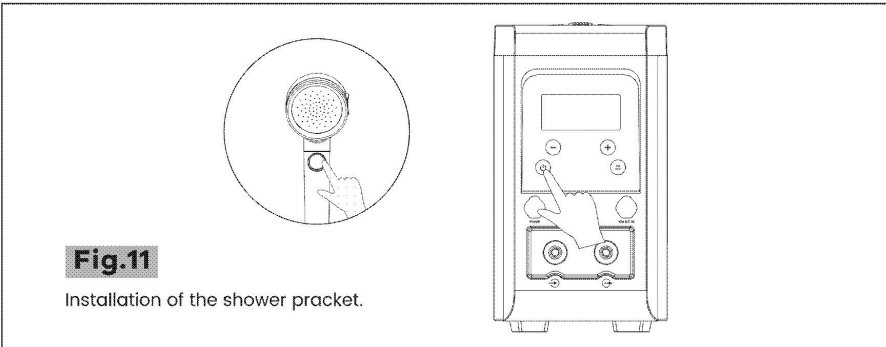

Fig.11

Installation of the shower packet.